

MACARTHUR SQUARE

STREETSCAPE WORKS & PARK UPGRADE

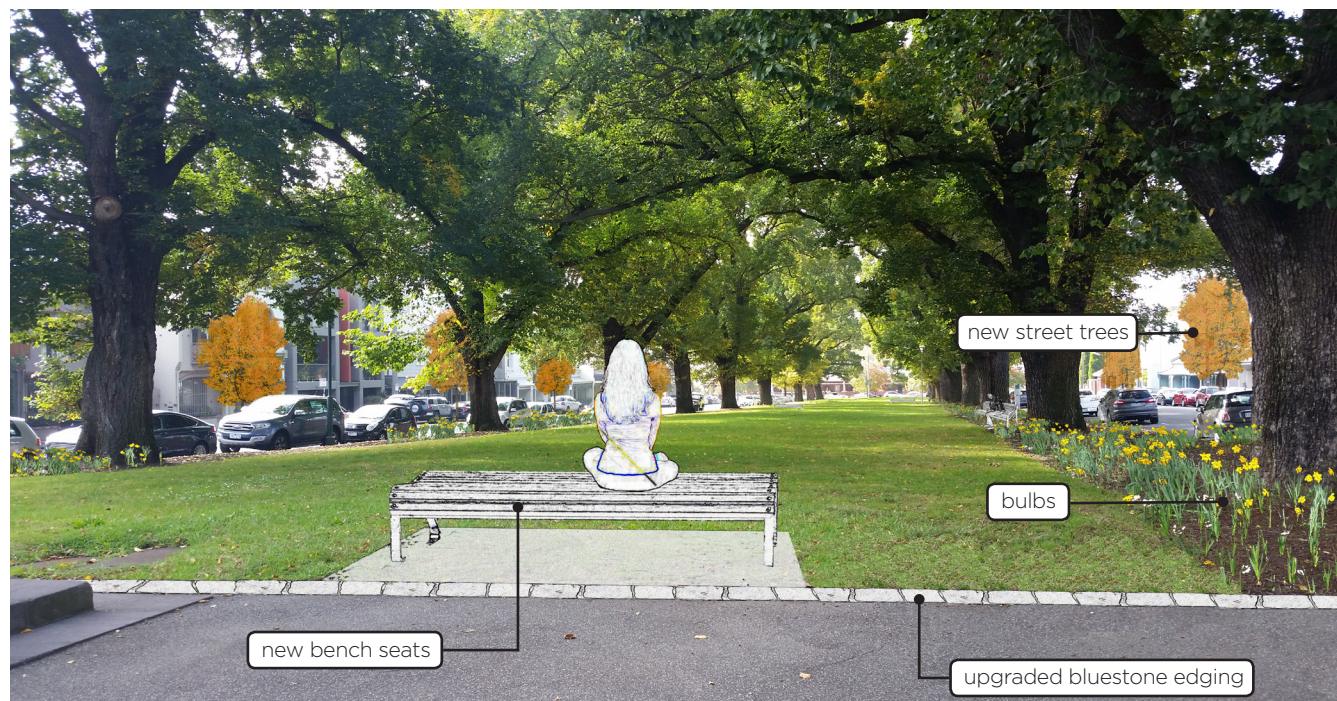

Proposed conditions Macarthur Square - looking east
(NOTE: bulbs may flower in varying seasons dependent on selected species)

Macarthur Square

In late 2016, City of Melbourne consulted with the Macarthur Square community about the potential to expand the parkland and improve the surrounding streetscapes.

The feedback indicated strong support to retain the current configuration of Macarthur Square including the heritage values and passive recreation activities such as sitting and picnicking.

The new proposal will offer minimal intervention to the Square, focusing on and consisting of:

- relocating and replacing lighting, power and furniture to improve views within the central green space
- providing additional park seating, lighting and bluestone edging

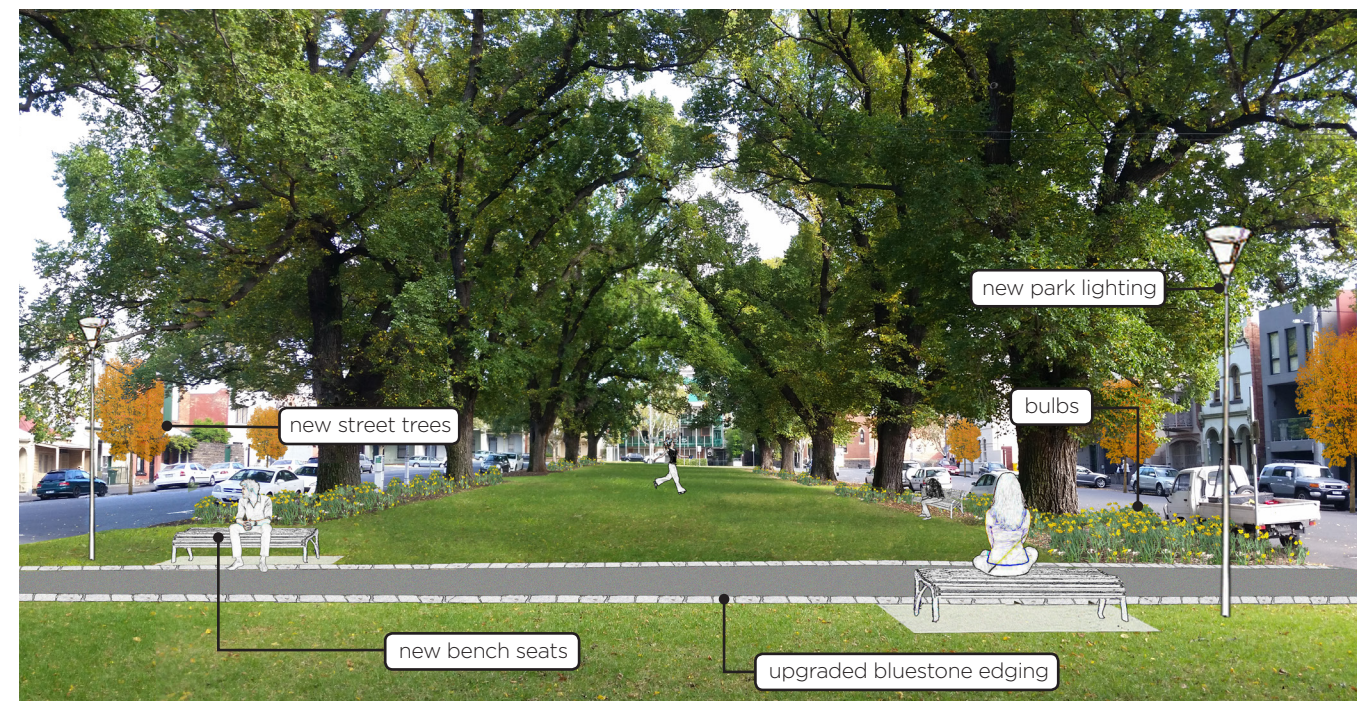

Proposed conditions Macarthur Square - looking west
(NOTE: bulbs may flower in varying seasons dependent on selected species)

- enhancing the park's horticultural value with seasonal bulb plantings under the avenues of Elm trees in the mulched areas.

Questions and feedback are welcomed from the community and we now have a survey available at:

participate.melbourne.vic.gov.au/macarthursquare

For further information about the project, please contact the City of Melbourne on 9658 9658 or email us at:

parkplanning@melbourne.vic.gov.au

FOR CONSULTATION

MACARTHUR SQUARE

STREETSCAPE WORKS & PARK UPGRADE

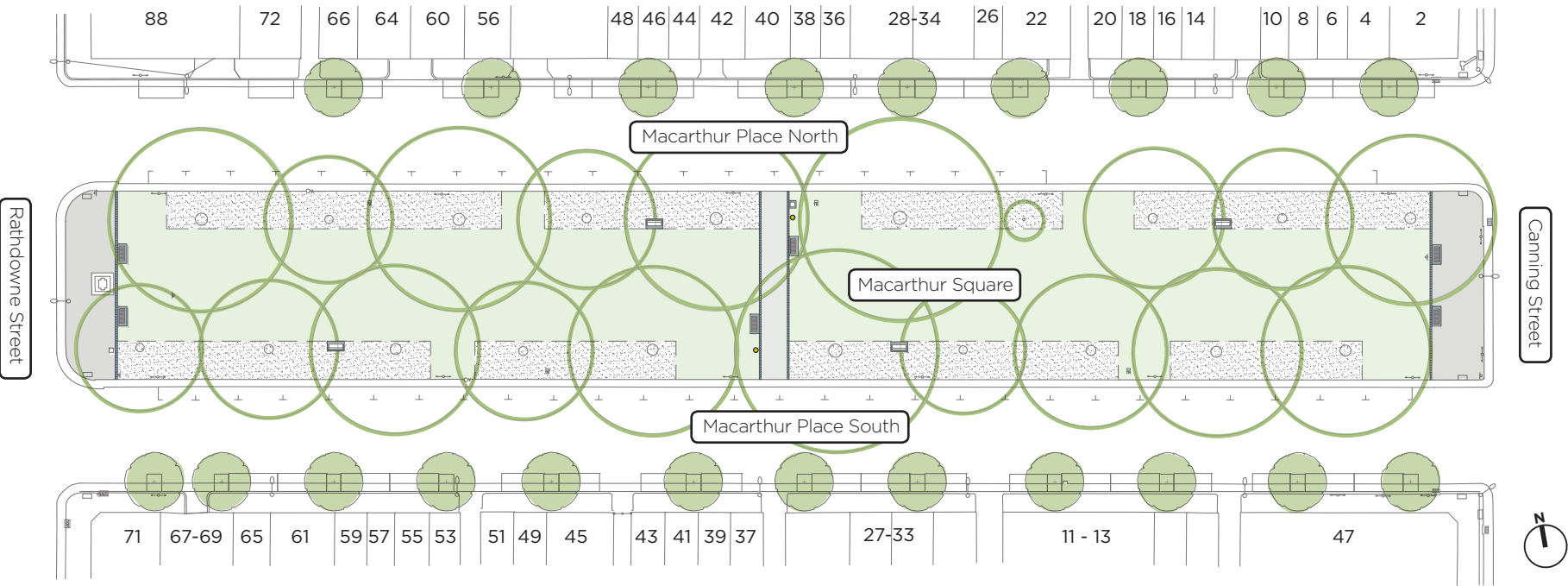

Proposed streetscape Macarthur Place South - looking west

- LEGEND**
- Existing Elm trees to be retained
 - New street trees in road *Fraxinus pennsylvanica* 'Cimmzam'
 - Bulb planting in mulched area under Elm trees
 - Existing lawn area to be retained
 - Sawn bluestone pitcher edge
 - Park seat with backrest
 - Bench seat
 - Litter bin
 - Park light

Street Tree Planting

Following community consultation, more than half of respondents supported the proposal to carry out streetscape works which will see the planting of 21 new trees.

The proposed species Green Ash (*Fraxinus pennsylvanica* 'Cimmzam') is a deciduous, medium-sized tree that has consistent form and tolerances to suit the expected growing conditions. This selection is consistent with the Carlton Urban Forest Precinct Plan.

New tree planting is proposed within the bluestone channel of the existing parking lane in Macarthur Place North and South. This would result in the loss of approximately 4 car parking spaces.

The existing Elm trees in Macarthur Square are ageing and it is important to plant trees now in anticipation of canopy loss.

Council's Urban Forest Strategy also aims to increase canopy cover in the public realm to 40% by 2040. To achieve this, the City of Melbourne is planting 3000 new trees each year. Macarthur Place North and South are identified for priority tree planting in the Carlton Urban Forest Precinct Plan.

Project Summary

Proposed number of street trees	21
Number of existing car parking spaces	95
Number of proposed car parking spaces	91

FOR CONSULTATION