

# HARDWARE LANE STREETSCAPE RENEWAL

CONCEPT DESIGN  
PLAN

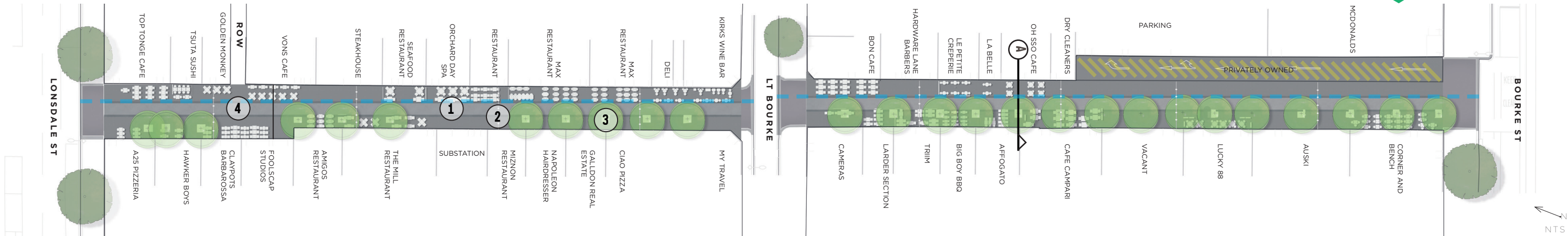

## DESIGN APPROACH

We're upgrading Hardware Lane to ensure it continues to be a vibrant, safe and accessible Melbourne Laneway into the future.

We'll do this by:

- 1 Upgrading the current road surface with varied bluestone paving treatment. This will create defined zones for pedestrians, diner and vehicles while retaining the existing functions of the street.
- 2 Upgrading lighting to meet Australian Standards and enhancing the character of Hardware Lane and its buildings.
- 3 Removing declining trees (*Robinia pseudoacacia* 'Frisia') to allow a new generation of trees to be planted with optimal growing conditions. Selected species will be consistent with the current street character.
- 4 Replacing drainage with increased capacity to meet current and future demands.

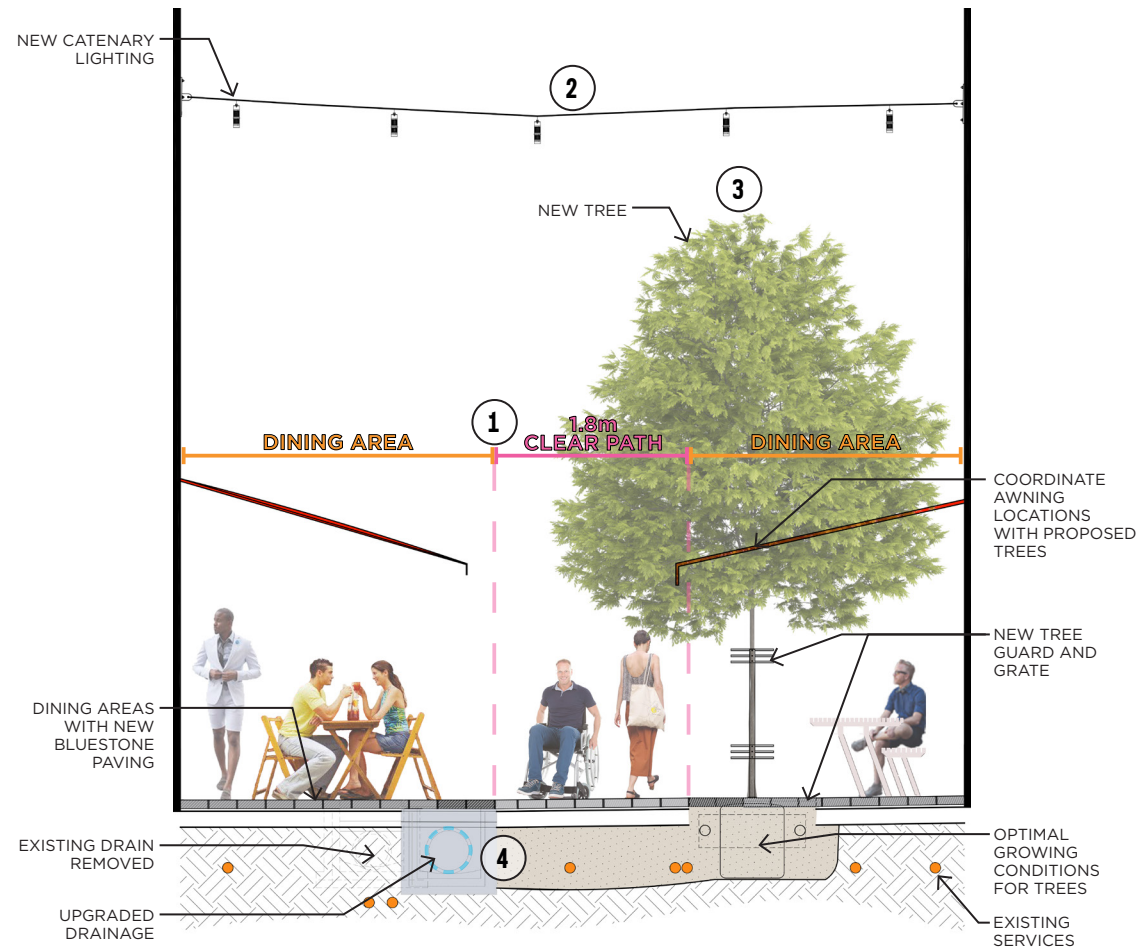

Constricted paths currently make access difficult.



Uneven and broken pavement is hazardous and unattractive.



Proposed Tree Species:  
*Gleditsia triacanthos* 'Sunburst'

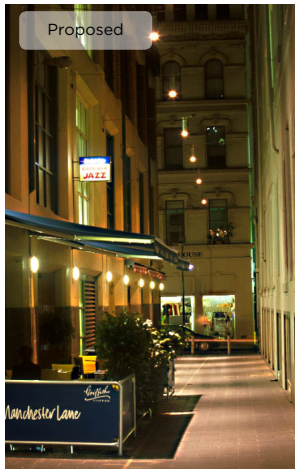

Proposed catenary lighting

