

# SCARBOROUGH PLACE, KENSINGTON

## STREET GREENING PROPOSAL

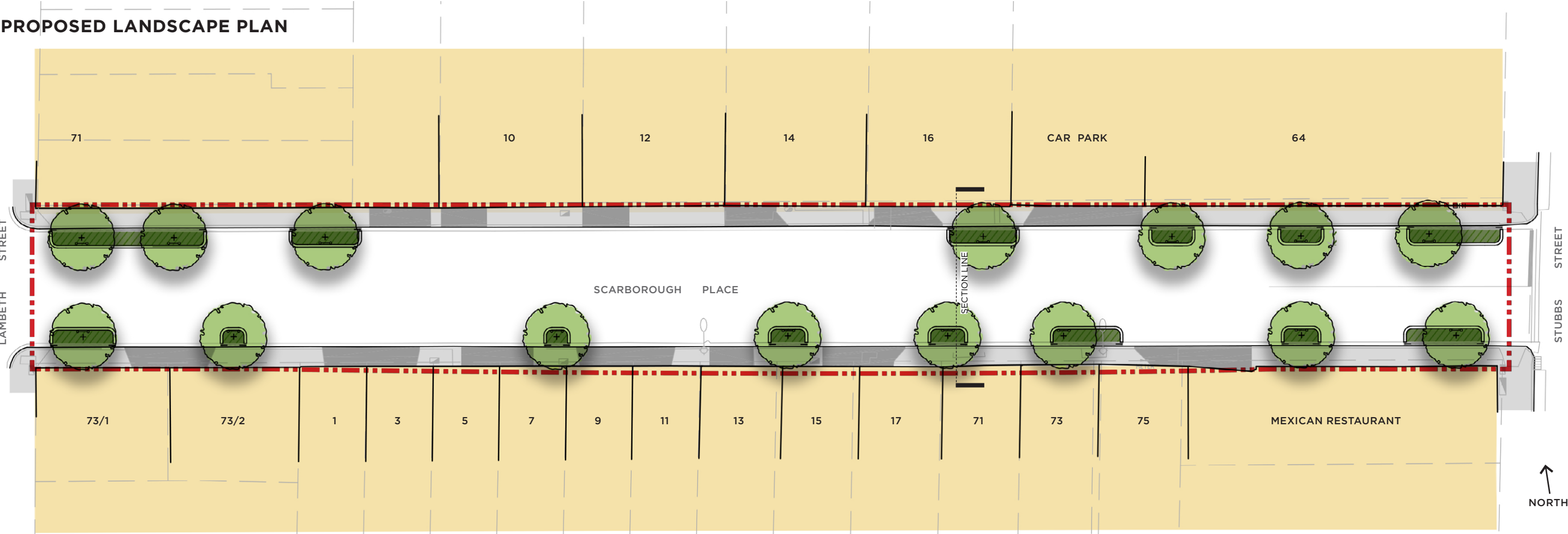

### PROJECT OVERVIEW

#### SCARBOROUGH PLACE, KENSINGTON

Our Street Greening Proposal recognises that this street is a key part of your neighbourhood and where you spend valuable time. You have told us that you want streets that are green and welcoming, with cooling canopy cover, street gardens, beautiful trees and safe traffic conditions.

The physical modification of existing roads and car parking is a challenging and resource intensive process, which will include some trade-offs, yet the anticipated outcomes will be highly beneficial.

- These improvements include:
- 15 new street trees creating shade and visual impact and increasing amenity for the community.
  - 60 m2 of permeable ground for natural absorption and rainwater filtration.
  - Narrower road to reduce the number and speed of 'through-way' vehicles.
  - Introduction of tree and understorey species that will strengthen urban forest resilience and plant community biodiversity, offering long-term benefit to the community.
  - The tree species has been identified as a tree that is highly likely to perform well in a changing climate, provide autumn interest and meets the guidelines of the Kensington Urban Forest Precinct Plan.

**LEGEND**

- Extent of works
- Proposed medium deciduous tree  
*Nyssa sylvatica* - Black Tupelo
- Biodiverse planting garden bed

- Existing footpath
- Existing driveway
- Tree hoop

**CONTACT**

Questions and feedback from the community are welcomed.

Tell us your thoughts about this proposal at [participate.melbourne.vic.gov.au/scarborough-place](https://participate.melbourne.vic.gov.au/scarborough-place)

**Telephone:** 03 9658 9658

**Email:** [greeningmelbourne@melbourne.vic.gov.au](mailto:greeningmelbourne@melbourne.vic.gov.au)

### PROPOSED SPECIES



*Nyssa sylvatica*  
Black Tupelo



CHANGES YOU CAN EXPECT

As older commercial buildings are being converted into residential developments, the needs of the communities that call Scarborough Place home, are changing. This project looks to transform the streetscape into an environment that is both safe and responsive for the current and future community.

Transforming the look, feel, and function of these streets entails several fundamental changes. These changes include the review of existing car parking conditions. We will transform eight car parking spaces with street trees and understory plantings. Eight on-street parking spaces will be retained. Scarborough Place, would continue to provide two lanes of traffic, though these lanes would be narrower. Our Traffic Study suggests these changes would naturally slow the speed of cars, creating a safer and more pleasant environment for people who are walking, cycling, or gardening.

We're inviting community feedback about this proposal to inform our final design.

To implement this proposal, there will be some temporary noise and access disruption, which we will communicate to residents in advance.

DESIGN SUMMARY

TREES

Existing street trees	0
Proposed street trees	15
Proposed Total	15 trees

PERMEABLE SURFACE AREA

Existing permeable surface	0
Proposed permeable surface	60
Proposed Total	60 m²

PARKING

Existing (estimated)	16
Proposed (estimated)	8

PROPOSED GARDEN BED



PASSIVE IRRIGATION TREE PITS TO REDUCE STORMWATER RUN-OFF AND PROMOTE FASTER GROWTH

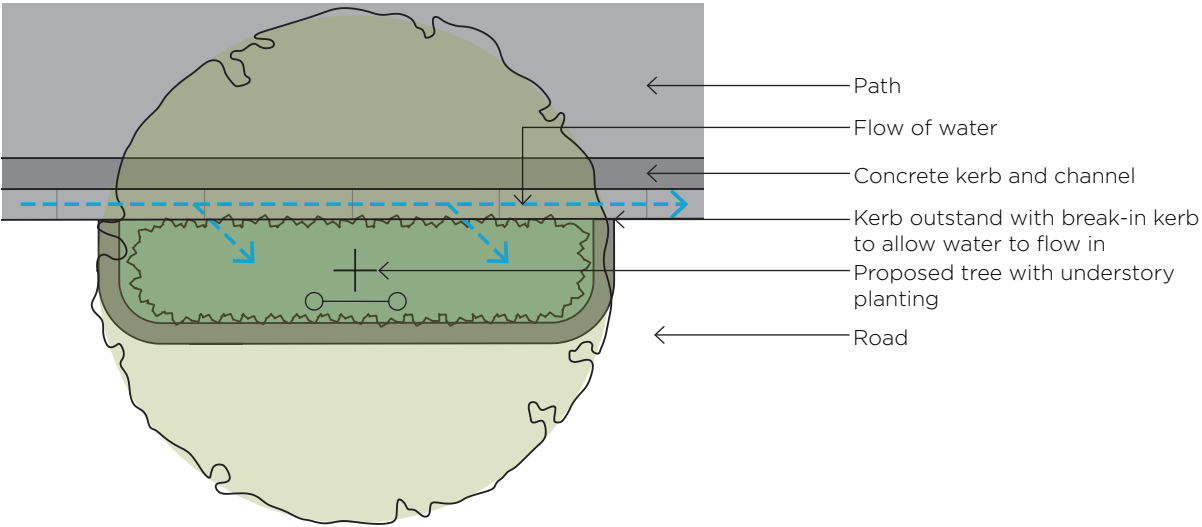

SCARBOROUGH PLACE - EXISTING SECTION

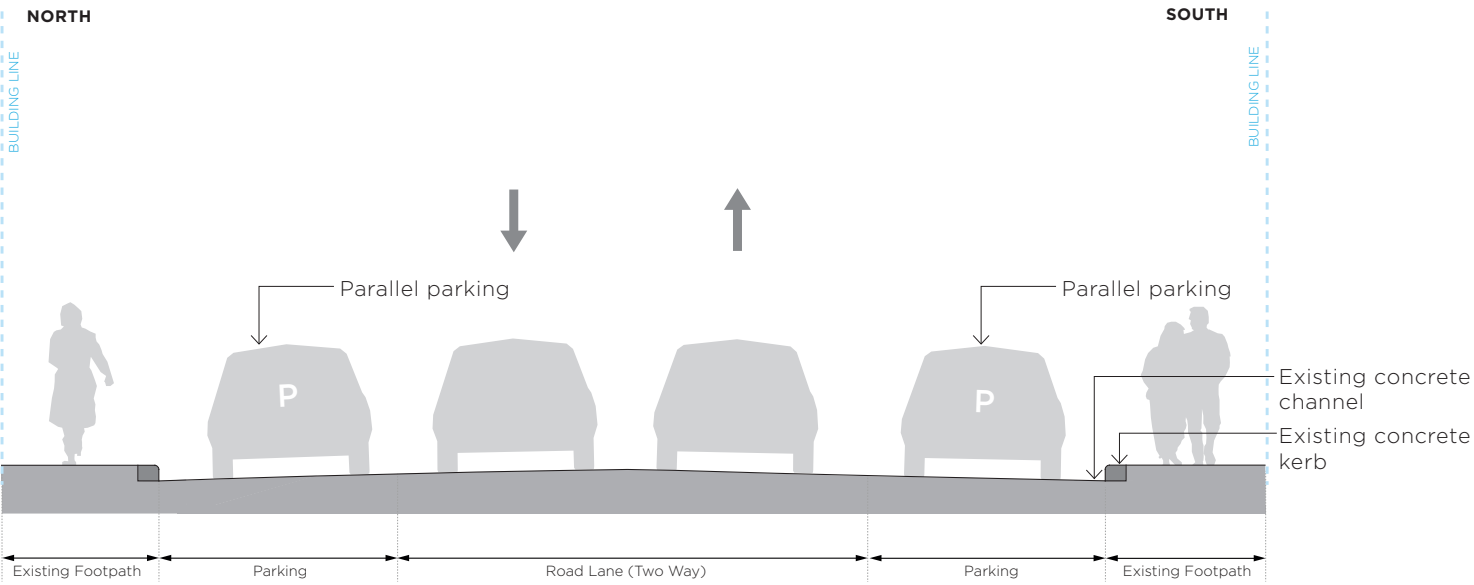

SCARBOROUGH PLACE - PROPOSED SECTION

